

Aspect Industrial Estate - Lot 6 (On Lot Works)

Mamre Road, Kemps Creek

Landscape Development Application

Drawing Schedule

Drawing Number	Drawing Title	Scale
WH6_000	Landscape Coversheet	N/A
WH6_001	Proposed Plant Schedule	N/A
WH6_101	Landscape Plan - Lot 6	1:150
WH6_102	Landscape Plan - Lot 6	1:150
WH6_103	Landscape Plan - Lot 6	1:150
WH6_104	Landscape Plan - Lot 6	1:150
WH2_501	Landscape Details	As Shown

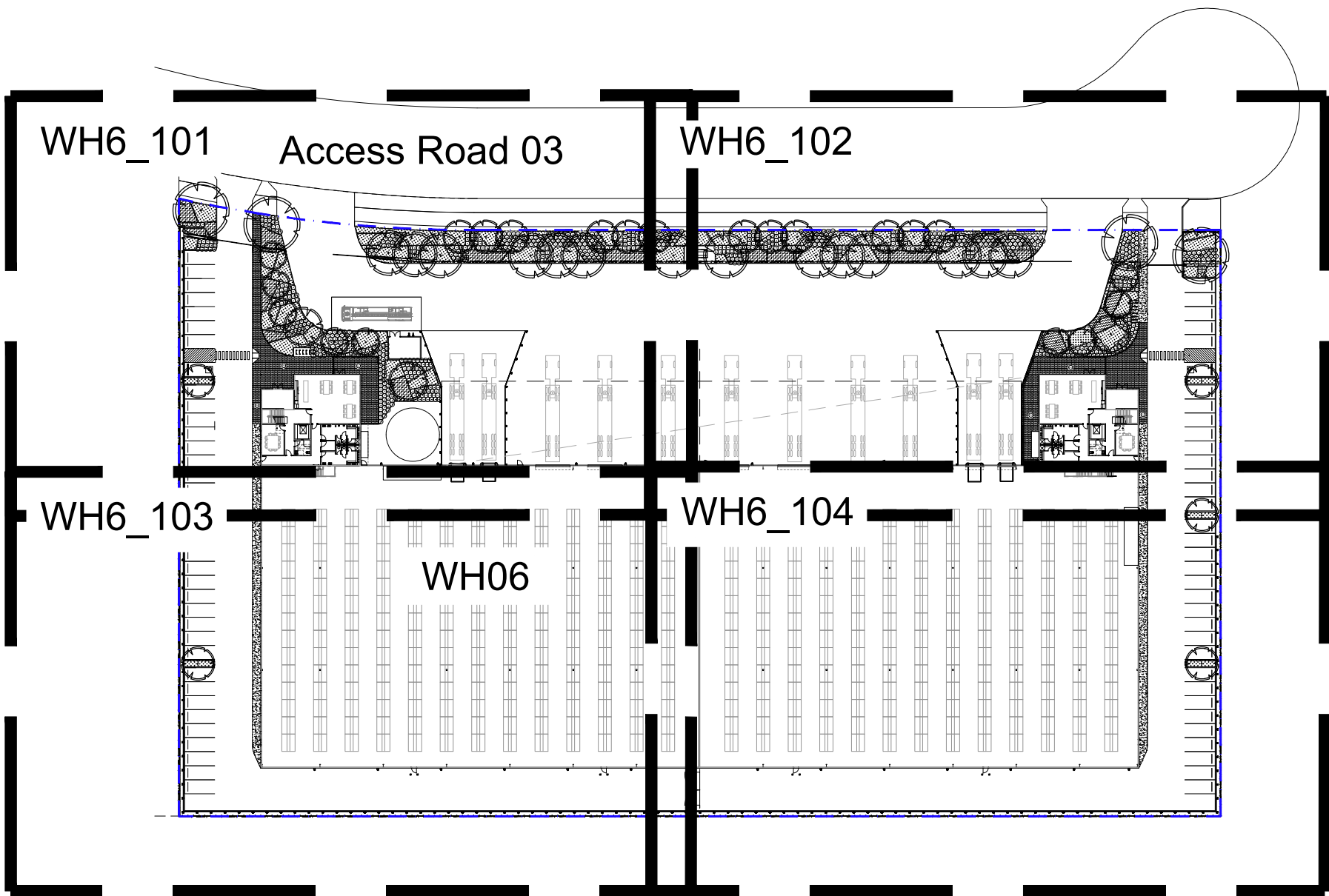

Scale 1: 1000

NOT FOR CONSTRUCTION

© 2019 Site Image (NSW) Pty Ltd ABN 44 801 262 380 as agent for Site Image NSW Partnership. All rights reserved. This drawing is copyright and shall not be reproduced or copied in any form or by any means (graphic, electronic or mechanical including photocopy) without the written permission of Site Image (NSW) Pty Ltd. Any license, expressed or implied, to use this document for any purpose what so ever is restricted to the terms of the written agreement between Site Image (NSW) Pty Ltd and the instructing party.

The contractor shall check and verify all work on site (including work by others) before commencing the landscape installation. Any discrepancies are to be reported to the Project Manager or Landscape Architect prior to commencing work. Do not scale this drawing. Any required dimensions not shown shall be referred to the Landscape Architect for confirmation.

Issue	Revision Description	Drawn	Check	Date
D	Architectural Coordination	CS	NM	14.10.2024
C	Response To Comment	CS	NM	22.02.2024
B	Response To Comment	CS	NM	12.02.2024
A	For Comment	CS	NM	31.01.2024

LEGEND

Key Plan:

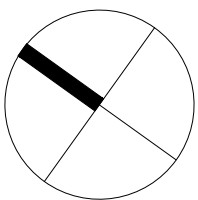

S I T E I M A G E

Landscape Architects
Level 1, 3-5 Baptist Street
Redfern NSW 2016
Australia
Tel: (61 2) 8332 5600
Fax: (61 2) 9698 2877
www.siteimage.com.au

Client:
Mirvac

Project:
Aspect Industrial Estate
Mamre Rd
Kemps Creek

Drawing Name:
Cover Sheet
Lot 6

Scale:
Job Number: SS19-4178
Drawing Number: LS-AIE.BO6.DA.000
Issue: D

PRELIMINARY

Proposed Plant Schedule Lot 6								
	Botanic Name	Common Name	Mature Size (h x w) (m)	Pot Size	Spacing	Quantity	Endemic Vegetation Community	DCP
TREES								
Bc	<i>Backhousia citrifolia</i>	Lemon Myrtle	8 x 5	200 L	As Shown	5		
Cm	<i>Corymbia maculata</i>	Spotted Gum	30 x 8	100L	As Shown	8		
Ep	<i>Eucalyptus punctata</i>	Grey Gum	25 x 8	100L	As Shown	6		
Es	<i>Eucalyptus sclerophylla</i>	Scribbly Gum	15 x 6	100L	As Shown	12		
Fa	<i>Flindersia australis</i>	Crow's Ash	12 x 7	200L	As Shown	3		
Hf	<i>Hymenosporum flavum</i>	Native Frangipani	8 x 5	200L	As Shown	4		
Lc	<i>Lophostemon confertus</i>	Queensland Brush Box	15 x 10	100L	As Shown	4		
Ms	<i>Melaleuca styphelioides</i>	Prickly Leaved Paperbark	8 x 6	100L	As Shown	6		
SHRUBS & ACCENTS								
Cc	<i>Callistemon citrinus</i>	Crimson Bottlebrush	3 x 2	200mm	As Shown	53		
Ce	<i>Coronidium elatum</i>	White Paper Daisy	1 x 1	200mm	As Shown	48		
Dc	<i>Dodonaea viscosa subsp. cuneata</i>	Wedge-leaf Hop-bush	1 x 2	300mm	As Shown	132		
Gj	<i>Grevillea juniperina</i>	Prickly Spider Flower	0.4 x 3	300mm	As Shown	135		
Ia	<i>Indigofera australis</i>	Australian Indigo	1.5 x 1.5	200mm	As Shown	130		
Mm	<i>Myoporum montanum</i>	Western Boobialla	4 x 3	300mm	As Shown	184		
Wf	<i>Westringia fruticosa</i>	Coastal Roosemary	2 x 2	300mm	As Shown	227		
GRASSES AND GROUNDCOVERS								
Aa	<i>Ajuga australis</i>	Australian Bugle	0.5 x spreading	150mm	5/m2	187		
Cap	<i>Carex appressa</i>	Tall Sedge	0.8 x 0.7	150mm	5/m2	434		
Capi	<i>Chryscephalum apiculatum</i>	Yellow Buttons	0.5 x 0.9	150mm	5/m2	247		
Dca	<i>Dianella caerulea</i>	Blue Flax Lily	.75 x .75	150mm	5/m2	296		
DI	<i>Dianella longifolia</i>	Pale Flax-lily	1.2 x 0.7	150mm	5/m2	379		
Hs	<i>Hibbertia scandens</i>	Snake Vine	0.2 x spreading	150mm	5/m2	195		
Hv	<i>Hardenbergia violacea</i>	Purple Coral Pea	0.5 x spreading	150mm	5/m2	235		
Lf	<i>Lomandra filiformis</i>	Wattle Mat-rush	0.25 x 0.2	150mm	5/m2	423		
LI	<i>Lomandra longifolia</i>	Mat Rush	1 x 1	150mm	5/m2	608		
Mp	<i>Myoporum parvifolium</i>	Creeping Boobialla	0.3 x spreading	150mm	5/m2	228		
PI	<i>Poa labillardieri</i>	Poa	1 x 0.5	150mm	5/m2	496		
Tj	<i>Trachelospermum jasminoides</i>	Star Jasmine	0.3 x spreading	150mm	5/m2	192		

NOTE:
Final plant species
selection subject to review.

NOT FOR CONSTRUCTION

© 2019 Site Image (NSW) Pty Ltd ABN 44 801 262 380 as agent for Site Image NSW Partnership. All rights reserved. This drawing is copyright and shall not be reproduced or copied in any form or by any means (graphic, electronic or mechanical including photocopy) without the written permission of Site Image (NSW) Pty Ltd. Any license, expressed or implied, to use this document for any purpose what so ever is restricted to the terms of the written agreement between Site Image (NSW) Pty Ltd and the instructing party.

The contractor shall check and verify all work on site (including work by others) before commencing the landscape installation. Any discrepancies are to be reported to the Project Manager or Landscape Architect prior to commencing work. Do not scale this drawing. Any required dimensions not shown shall be referred to the Landscape Architect for confirmation.

C	Architectural Coordination	CS	NM	14.10.2024
B	Response To Comment	CS	NM	22.02.2024
A	Response To Comment	CS	NM	12.02.2024
Issue	Revision Description	Drawn	Check	Date

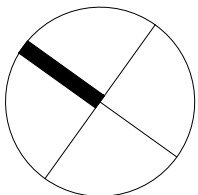

S I T E I M A G E

Landscape Architects

Level 1, 3-5 Baptist Street
Redfern NSW 2016
Australia

Tel: (61 2) 8332 5600
Fax: (61 2) 9698 2877
www.siteimage.com.au

Client:
Mirvac

Project:
**Aspect Industrial Estate
Mamre Rd
Kemps Creek**

Drawing Name:
**Proposed Plant Schedule
Lot 6**

Scale: 1:150 @ A1

Job Number:
SS19-4178

Drawing Number:
LS-AIE.BO6.DA.001

Issue:
C

PRELIMINARY

NOT FOR CONSTRUCTION

© 2019 Site Image (NSW) Pty Ltd ABN 44 801 262 380 as agent for Site Image NSW Partnership. All rights reserved. This drawing is copyright and shall not be reproduced or copied in any form or by any means (graphic, electronic or mechanical including photocopy) without the written permission of Site Image (NSW) Pty Ltd. Any license, expressed or implied, to use this document for any purpose what so ever is restricted to the terms of the written agreement between Site Image (NSW) Pty Ltd and the instructing party.

The contractor shall check and verify all work on site (including work by others) before commencing the landscape installation. Any discrepancies are to be reported to the Project Manager or Landscape Architect prior to commencing work. Do not scale this drawing. Any required dimensions not shown shall be referred to the Landscape Architect for confirmation.

D	Architectural Coordination
C	Response To Comment
B	Response To Comment
A	For Comment
Issue	Revision Description

CS	NM	14.10.2024
CS	NM	22.02.2024
CS	NM	12.02.2024
CS	NM	31.01.2024
Drawn	Check	Date

LEGEND

	Property Boundary
	Proposed Tree Refer to Plant Schedule
	Groundcover Planting Refer to Plant Schedule
	Proposed Shrubs Refer to Plant Schedule

	F1 - Chainmesh Fence Refer to Architect's Drawings
	F2 - Palisade Fence Refer to Architect's Drawings
	SE - Steel Edge Refer to Landscape Detail & Specification
	P1 - Unit Paving Refer Architectural Drawings

	P2 - Insitu Concrete Paving Refer Architectural Drawings
--	---

Key Plan:

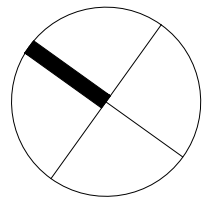
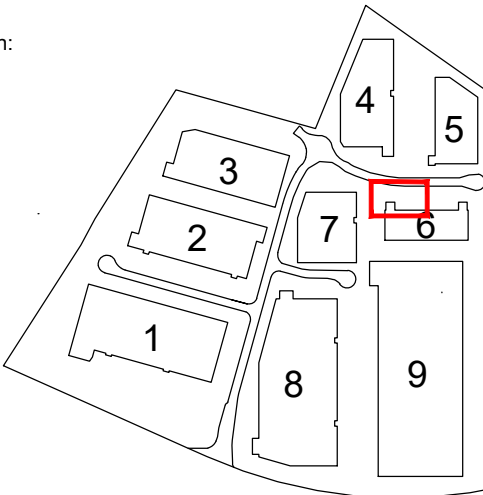

SITE IMAGE
Landscape Architects
Level 1, 3-5 Baptist Street
Redfern NSW 2016
Australia
Tel: (61 2) 8332 5600
Fax: (61 2) 9698 2877
www.siteimage.com.au

Client:
Mirvac

Project:
**Aspect Industrial Estate
Mamre Rd
Kemps Creek**

Drawing Name:
**Landscape Plan
Lot 6**

PRELIMINARY
Scale: 1:150 @ A1
Job Number: **SS19-4178**
Drawing Number: **LS-AIE.BO6.DA.101**
Issue: **D**

Access Road 03

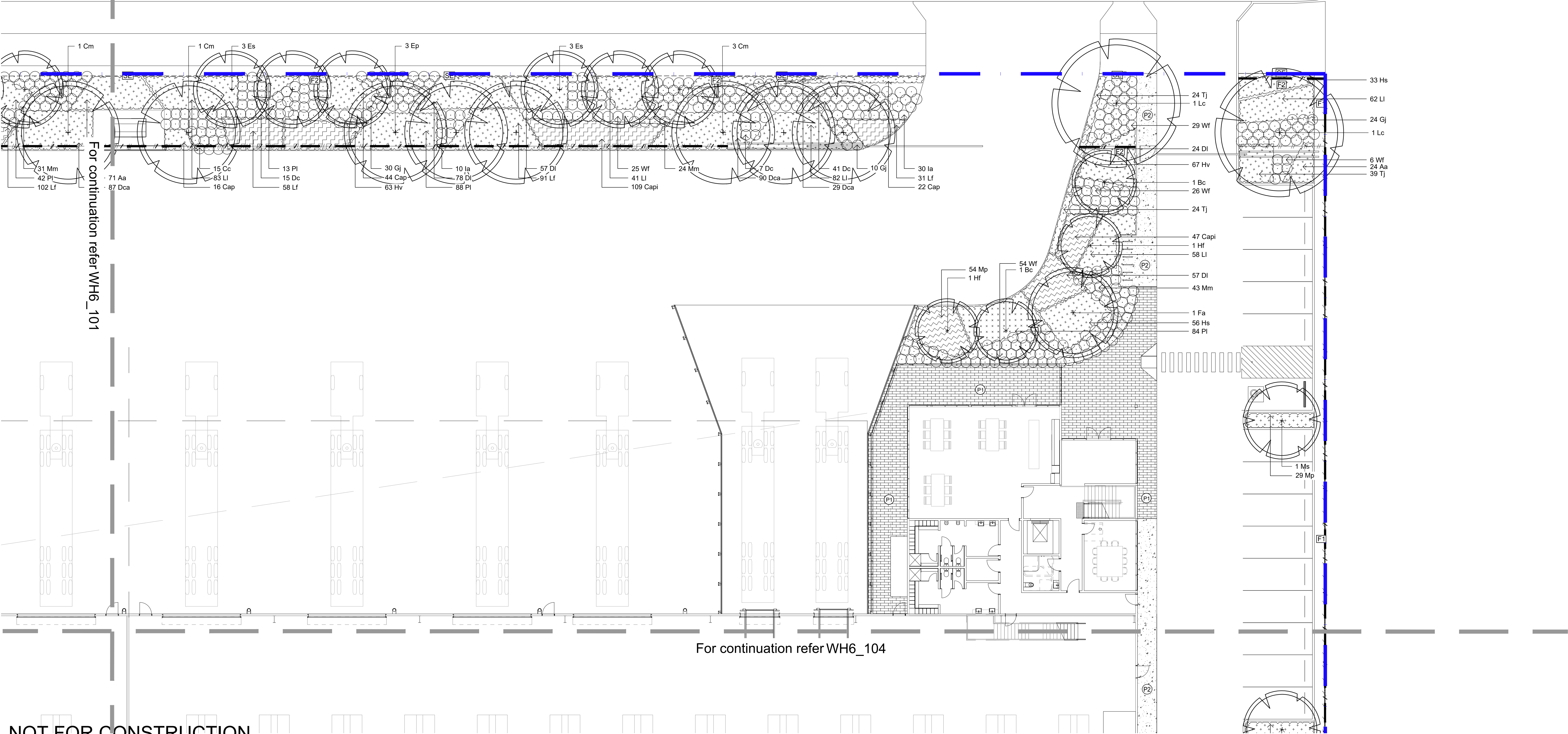

NOT FOR CONSTRUCTION

© 2019 Site Image (NSW) Pty Ltd ABN 44 801 262 380 as agent for Site Image NSW Partnership. All rights reserved. This drawing is copyright and shall not be reproduced or copied in any form or by any means (graphic, electronic or mechanical including photocopy) without the written permission of Site Image (NSW) Pty Ltd. Any license, expressed or implied, to use this document for any purpose what so ever is restricted to the terms of the written agreement between Site Image (NSW) Pty Ltd and the instructing party.

The contractor shall check and verify all work on site (including work by others) before commencing the landscape installation. Any discrepancies are to be reported to the Project Manager or Landscape Architect prior to commencing work. Do not scale this drawing. Any required dimensions not shown shall be referred to the Landscape Architect for confirmation.

D	Architectural Coordination
C	Response To Comment
B	Response To Comment
A	For Comment
Issue	Revision Description

CS	NM	14.10.2024
CS	NM	22.02.2024
CS	NM	12.02.2024
CS	NM	31.01.2024
Draw	Check	Date

LEGEND

	Property Boundary
	Proposed Tree Refer to Plant Schedule
	Groundcover Planting Refer to Plant Schedule
	Proposed Shrubs Refer to Plant Schedule

	F1 - Chainmesh Fence Refer to Architect's Drawings
	F2 - Palisade Fence Refer to Architect's Drawings
	SE - Steel Edge Refer to Landscape Detail & Specification
	P1 - Unit Paving Refer Architectural Drawings

	P2 - Insitu Concrete Paving Refer Architectural Drawings
--	---

Key Plan:

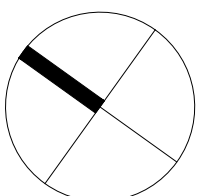
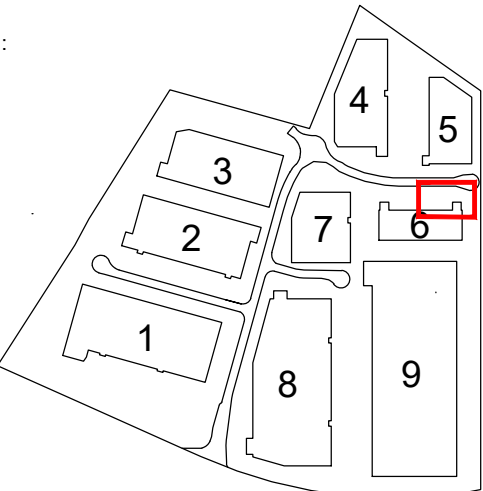

SITE IMAGE
Landscape Architects
Level 1, 3-5 Baptist Street
Redfern NSW 2016
Australia
Tel: (61 2) 8332 5600
Fax: (61 2) 9698 2877
www.siteimage.com.au

Client:
Mirvac

Project:
Aspect Industrial Estate
Mamre Rd
Kemps Creek

Drawing Name:
Landscape Plan
Lot 6

PRELIMINARY
Scale: 1:150 @ A1
Job Number: **SS19-4178**
Drawing Number: **LS-AIE.BO6.DA.102**
Issue: **D**

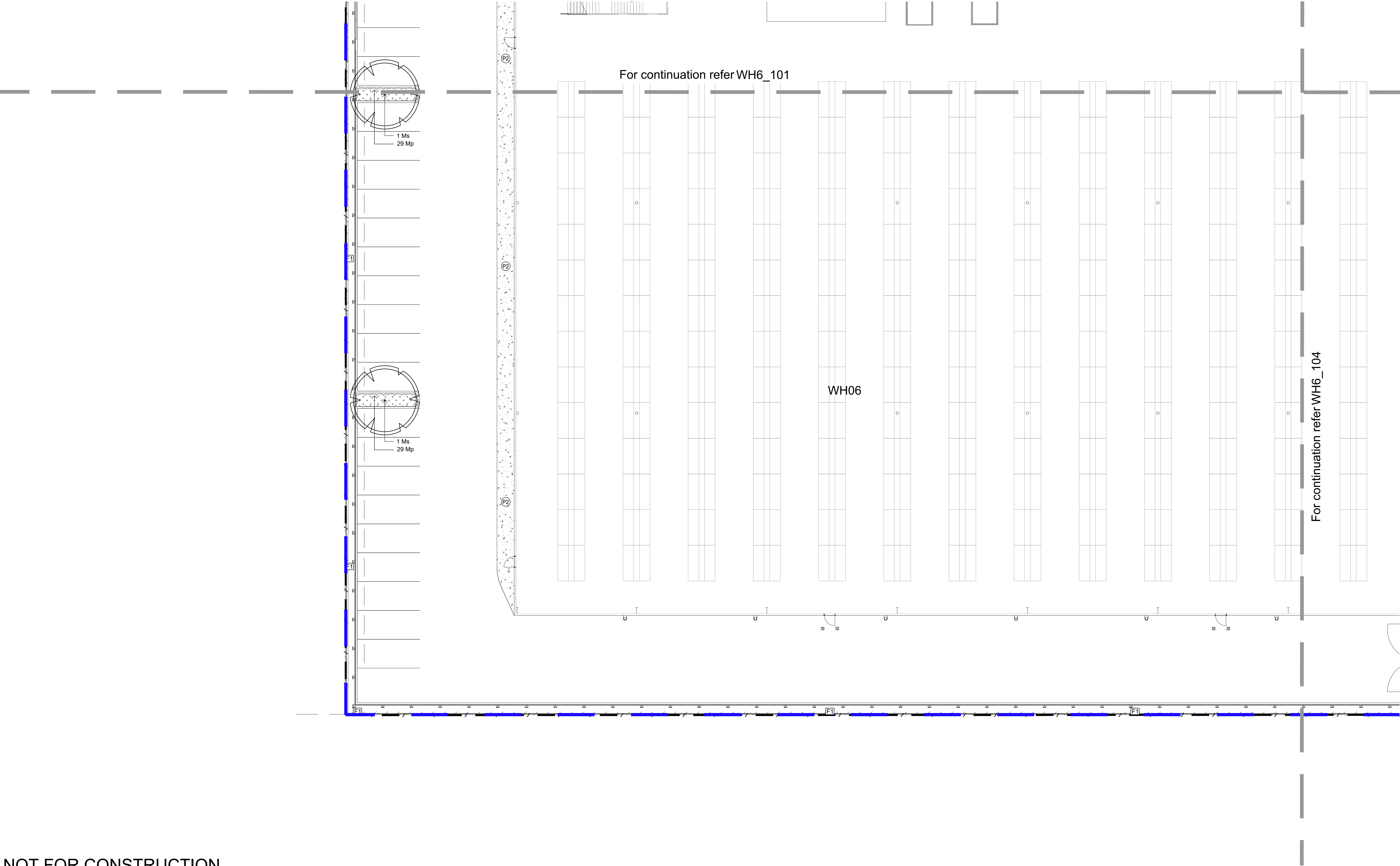

NOT FOR CONSTRUCTION

© 2019 Site Image (NSW) Pty Ltd ABN 44 801 262 380 as agent for Site Image NSW Partnership. All rights reserved. This drawing is copyright and shall not be reproduced or copied in any form or by any means (graphic, electronic or mechanical including photocopy) without the written permission of Site Image (NSW) Pty Ltd. Any license, expressed or implied, to use this document for any purpose what so ever is restricted to the terms of the written agreement between Site Image (NSW) Pty Ltd and the instructing party.

The contractor shall check and verify all work on site (including work by others) before commencing the landscape installation. Any discrepancies are to be reported to the Project Manager or Landscape Architect prior to commencing work. Do not scale this drawing. Any required dimensions not shown shall be referred to the Landscape Architect for confirmation.

D	Architectural Coordination
C	Response To Comment
B	Response To Comment
A	For Comment
Issue	Revision Description

CS	NM	14.10.2024
CS	NM	22.02.2024
CS	NM	12.02.2024
CS	NM	31.01.2024
Drawn	Check	Date

LEGEND	
	Property Boundary
	Proposed Tree Refer to Plant Schedule
	Groundcover Planting Refer to Plant Schedule
	Proposed Shrubs Refer to Plant Schedule

	F1 - Chainmesh Fence Refer to Architect's Drawings
	F2 - Palisade Fence Refer to Architect's Drawings
	SE - Steel Edge Refer to Landscape Detail & Specification
	P1 - Unit Paving Refer Architectural Drawings

	P2 - Insitu Concrete Paving Refer Architectural Drawings
--	---

Key Plan:

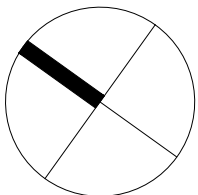
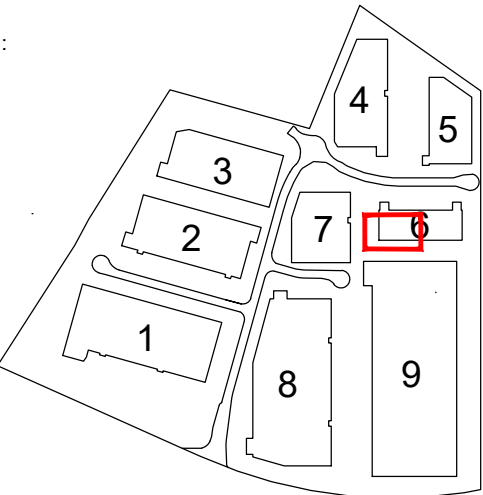

Client:
Mirvac

Project:
Aspect Industrial Estate
Mamre Rd
Kemps Creek

Drawing Name:
Landscape Plan
Lot 6

Scale: 1:150 @ A1
Job Number:

PRELIMINARY
Drawing Number:
SS19-4178 LS-AIE.B02.DA.103

Issue:

D

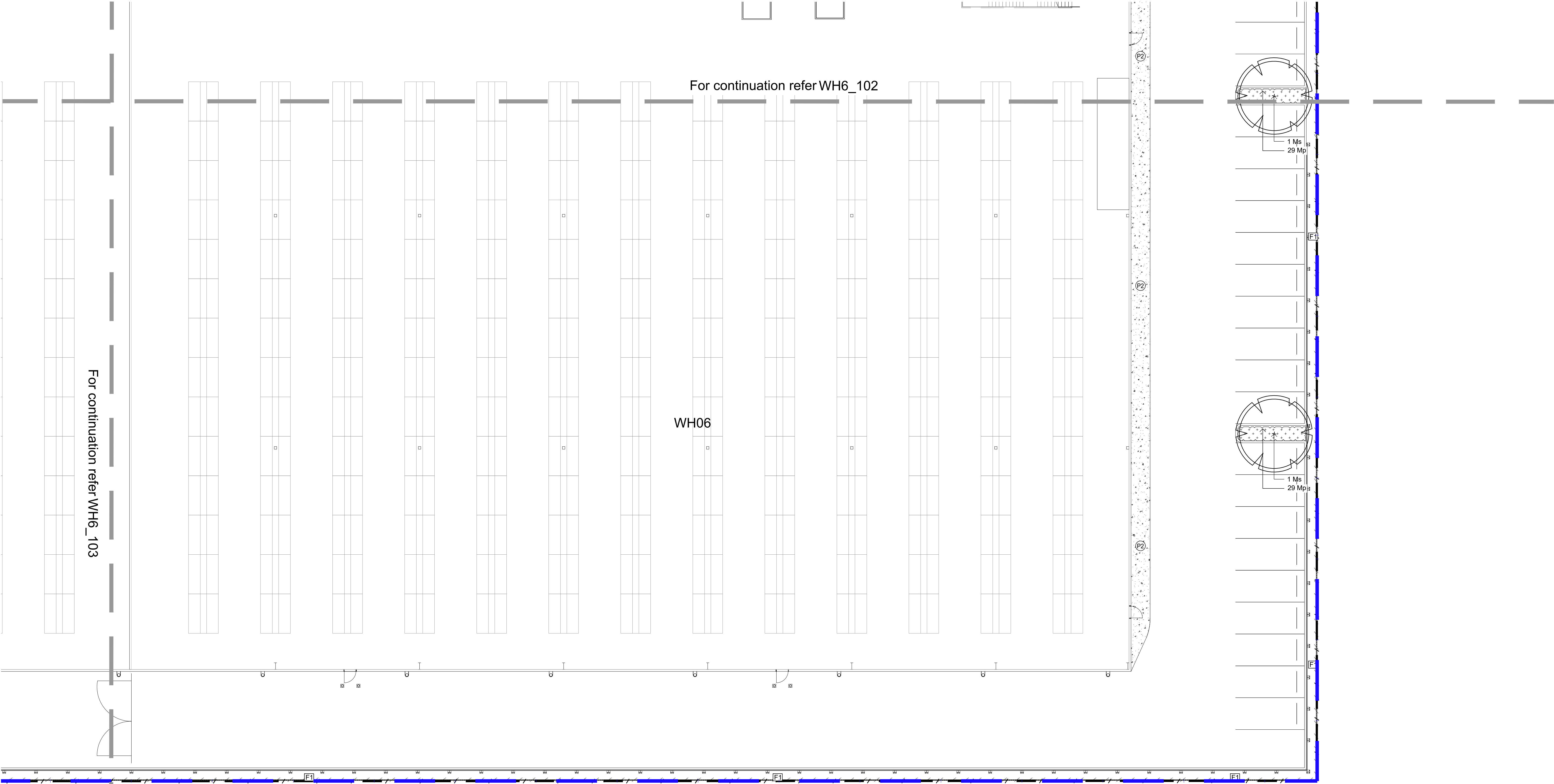

NOT FOR CONSTRUCTION

© 2019 Site Image (NSW) Pty Ltd ABN 44 801 262 380 as agent for Site Image NSW Partnership. All rights reserved. This drawing is copyright and shall not be reproduced or copied in any form or by any means (graphic, electronic or mechanical including photocopy) without the written permission of Site Image (NSW) Pty Ltd. Any license, expressed or implied, to use this document for any purpose what so ever is restricted to the terms of the written agreement between Site Image (NSW) Pty Ltd and the instructing party.

The contractor shall check and verify all work on site (including work by others) before commencing the landscape installation. Any discrepancies are to be reported to the Project Manager or Landscape Architect prior to commencing work. Do not scale this drawing. Any required dimensions not shown shall be referred to the Landscape Architect for confirmation.

D	Architectural Coordination
C	Response To Comment
B	Response To Comment
A	For Comment
Issue	Revision Description

CS	NM	14.10.2024
CS	NM	22.02.2024
CS	NM	12.02.2024
CS	NM	31.01.2024
Drawn	Check	Date

LEGEND

	Property Boundary
	Proposed Tree Refer to Plant Schedule
	Groundcover Planting Refer to Plant Schedule
	Proposed Shrubs Refer to Plant Schedule

	F1 - Chainmesh Fence Refer to Architect's Drawings
	F2 - Palisade Fence Refer to Architect's Drawings
	SE - Steel Edge Refer to Landscape Detail & Specification
	P1 - Unit Paving Refer Architectural Drawings

	P2 - Insitu Concrete Paving Refer Architectural Drawings
--	---

Key Plan:

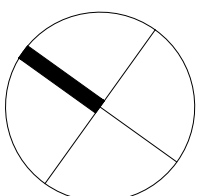
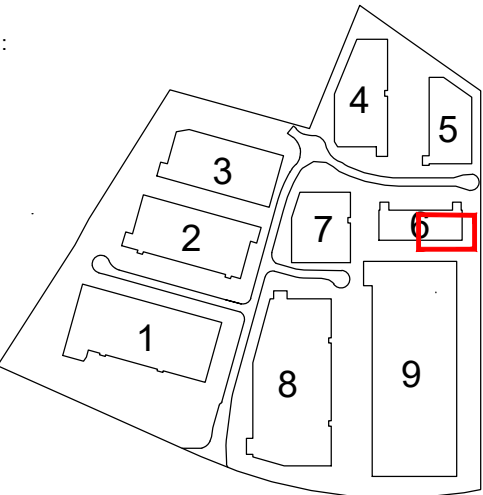

SITE IMAGE
Landscape Architects
Level 1, 3-5 Baptist Street
Redfern NSW 2016
Australia
Tel: (61 2) 8332 5600
Fax: (61 2) 9698 2877
www.siteimage.com.au

Client:
Mirvac

Project:
**Aspect Industrial Estate
Mamre Rd
Kemps Creek**

Drawing Name:
**Landscape Plan
Lot 6**

Scale: 1:150 @ A1
Job Number:
SS19-4178

PRELIMINARY
Drawing Number:
LS-AIE.BO6.DA.104

Issue:
D